

2009

PTO Pump

Optional Wet Kit

H&S

M6 & M9 MERGERS

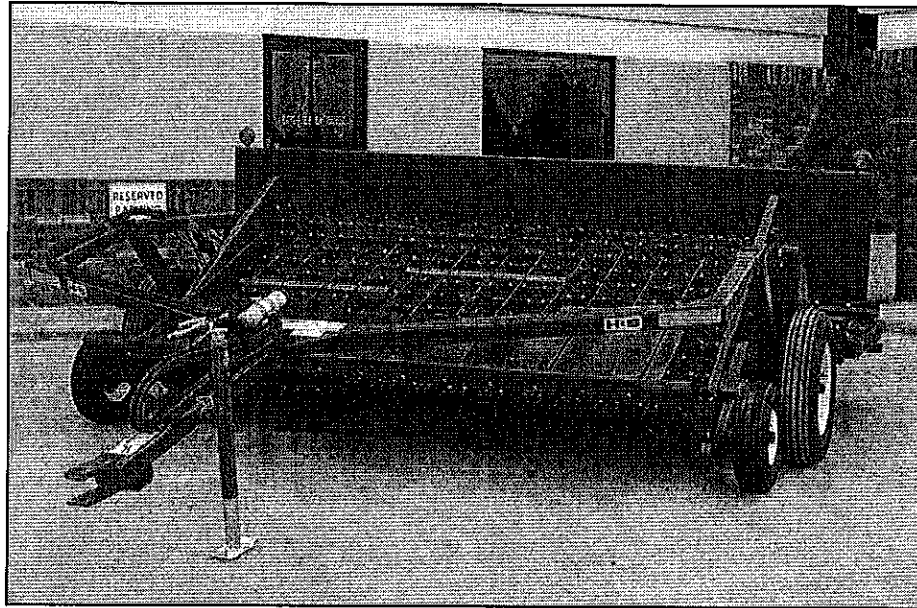

WARNING READ AND UNDERSTAND THIS MANUAL BEFORE OPERATING THIS EQUIPMENT.

UNSAFE OPERATION OR MAINTENANCE OF THIS EQUIPMENT CAN RESULT IN SERIOUS INJURY OR DEATH.

PARTS & OPERATOR'S INSTRUCTIONS

2-11-2009

Manufactured By
H&S MANUFACTURING CO., INC.
P.O. BOX 768 • (715) 387-3414 FAX (715) 384-5463
MARSHFIELD, WISCONSIN 54449

FIGURE 1

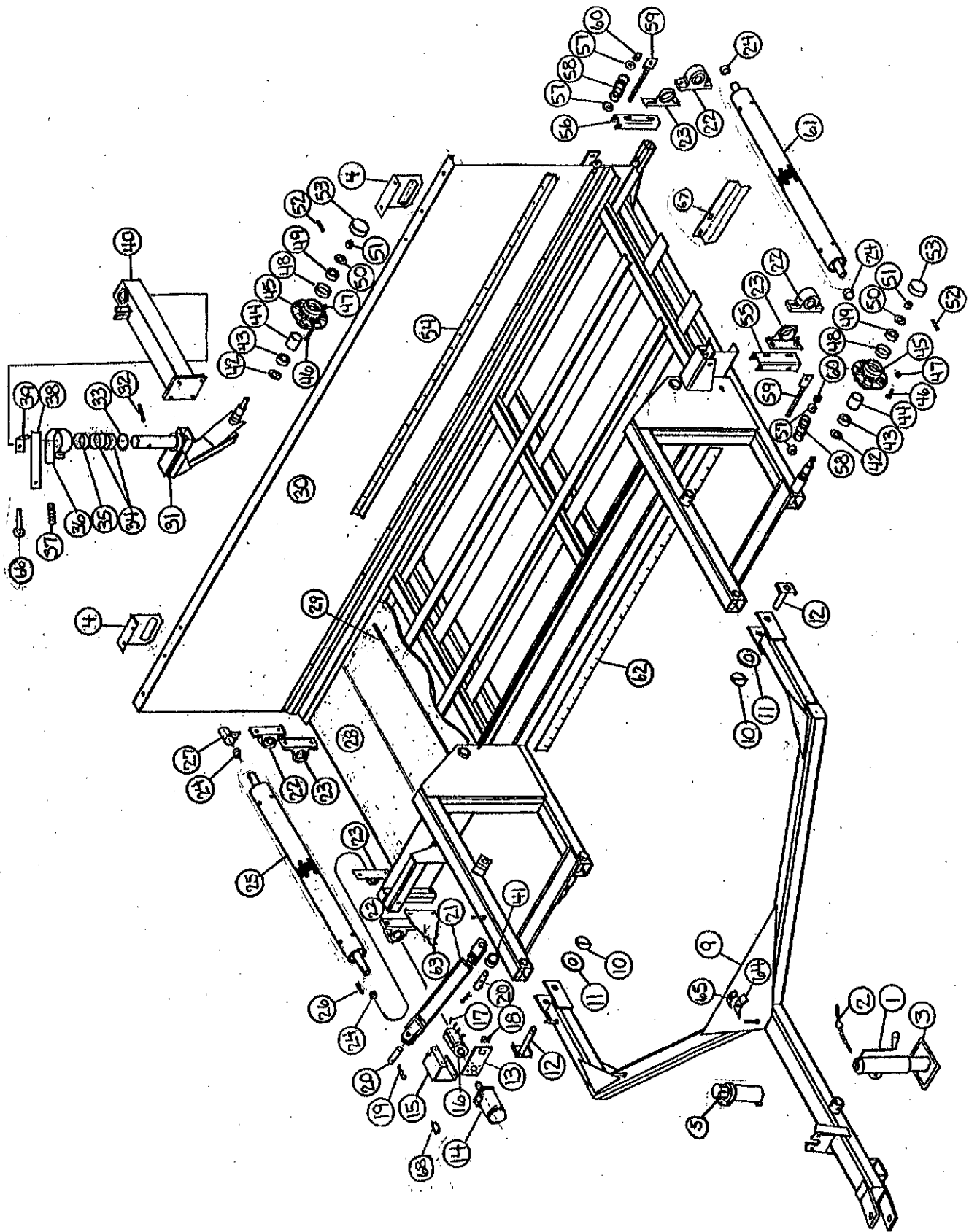

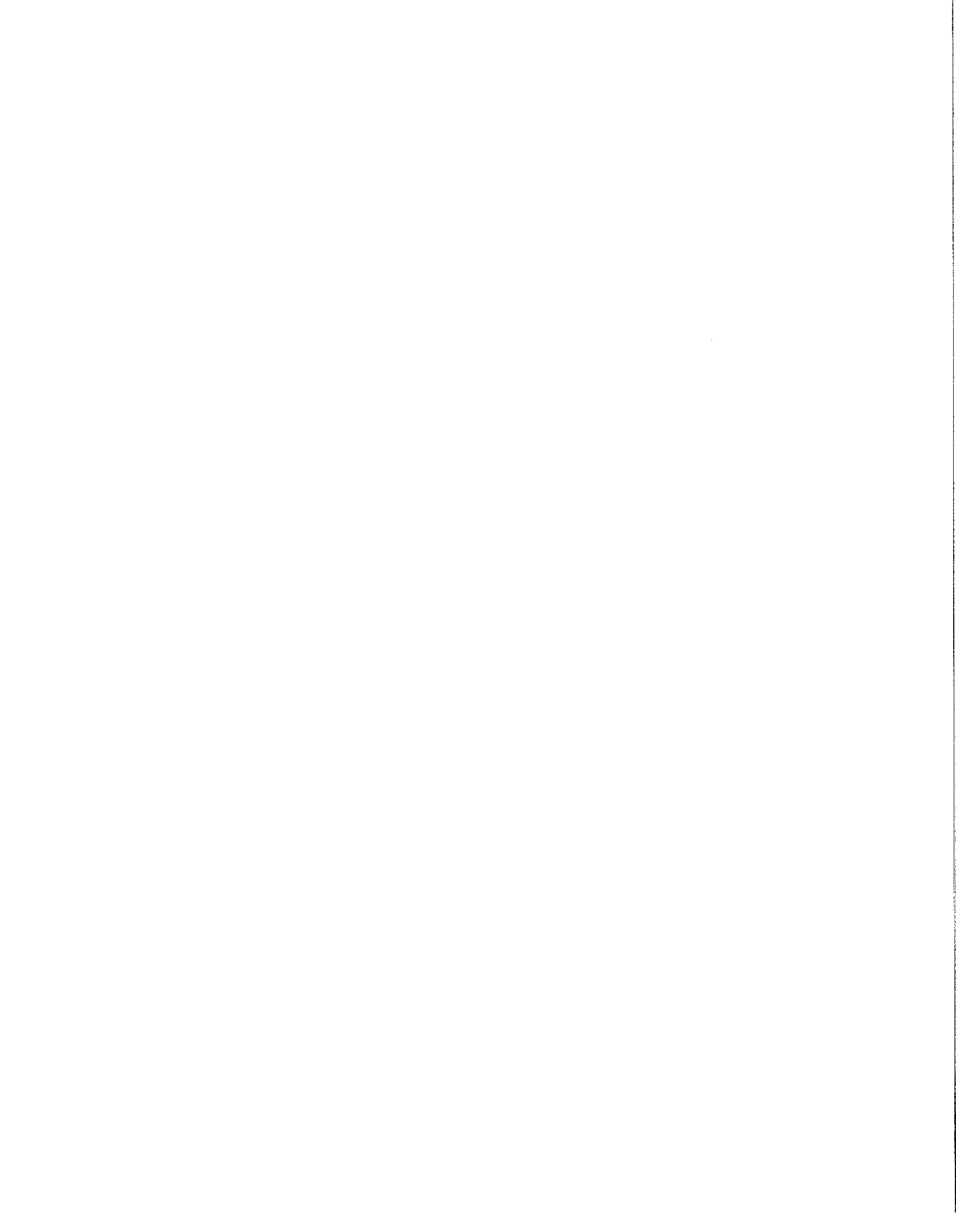

FIGURE 1
6' & 9' MERGER MAIN FRAME/POLE

ITEM	PART NO.		DESCRIPTION	ITEM	PART NO.		DESCRIPTION
	6' HEAD	9' HEAD			6' HEAD	9' HEAD	
1.	B17B	"	Jack Handle	36.	WM286	"	Brake Band
2.	BFR4	"	Jack Pin & Chain	37.	WM210	"	Spring-Red
3.	BFR223	"	Jack	38.	WM288	"	Brake Pad
4.	SWM28	"	Light Bracket	39.	WM211	"	Brake Angle
5.	S522	"	Manual Holder	40.	SWM3	"	Caster Mount
9.	SWM5	SWM65	Pole	41.	K132	"	Spacer
10.	F56	"	Lynch Pin	42.	BFR57	"	Seal
11.	SWM36	"	Washer-Pivot	43.	BFR58	"	Inner Bearing
12.	SWM14	"	Pivot Pin	44.	BFR59	"	Inner Race
13.	DWM39	"	Torque Arm	45.	BFR60	"	Hub
14.	DF1	"	Hydraulic Motor	*	BFR67	"	Wheel 5 x 15 (3)
*	WM225	"	Seal Kit	*	BFR128	"	Tire 6.70 x 15SL (3)
15.	DWM42	"	Right Motor Shield	46.	BFR143	"	Stud Bolt
16.	DWM27	"	Coupler	47.	BFR144	"	Nut
17.	DWM137	"	Cap Screw-Coupler	48.	BFR61	"	Outer Race
18.	DWM45	"	Motor Spacer	49.	BFR62	"	Outer Bearing
19.	R70	"	Cotter Pins 3/16" x 2"	50.	BFR63	"	Washer
20.	BFR517	"	Cylinder Pin	51.	BFR64	"	Nut
21.	BFR69A	"	Cylinder	52.	BFR65	"	Cotter Pin
22.	DWM132	"	Pillow Block Bearing	53.	BFR66	"	Hub Cap
23.	DWM36	"	Anti-Wrap Guard	54.	SWM29	WM236	Skirt
24.	SWM30	"	Head Spacer	55.	SWM34	"	Tightener Arm
25.	SWM11	"	Driver Roller	56.	SWM33	"	Back Tightener Arm
26.	G23	"	Key 5/16" x 1-3/8"	57.	K68	"	Washer 1/2"
27.	DWM31	"	Shaft Shield	58.	DWM125	"	Spring-Blue
28.	SWM19	WM237	Conveyor Belt	59.	DWM25	"	Tightener
29.	SWM37	"	Lacing Pin	60.	R29	"	Nut 1/2"
*	SWM38	"	Cross Conveyor Lacing	61.	SWM10	"	Conveyor Roller
30.	SWM7	SWM66	Main Frame	62.	SWM16	WM235	Skirt Belt
31.	SWM2	"	Caster	63.	DWM51	"	Male Torque Arm
32.	BFR313	"	Roll Pin 5/16" x 2-3/4"	64.	HE42	"	Hose Holder (6)
33.	RG24	"	Bronze Washer 2"ID x 3"OD x 1/8"	65.	23N67	"	Hose Holder (4)
34.	BFR527	"	Bronze Bushing 2"ID x 2-1/4"OD x 2"	66.	WM287	"	I-Bolt
35.	DWM59	"	Brake Bushing	67.	SWM59	"	Skirt Extention
				68.	5B10	"	Key 1/4" x 1" Woodruff

* (Means Not Shown)

" (Means Same As Previous)

FIGURE 2

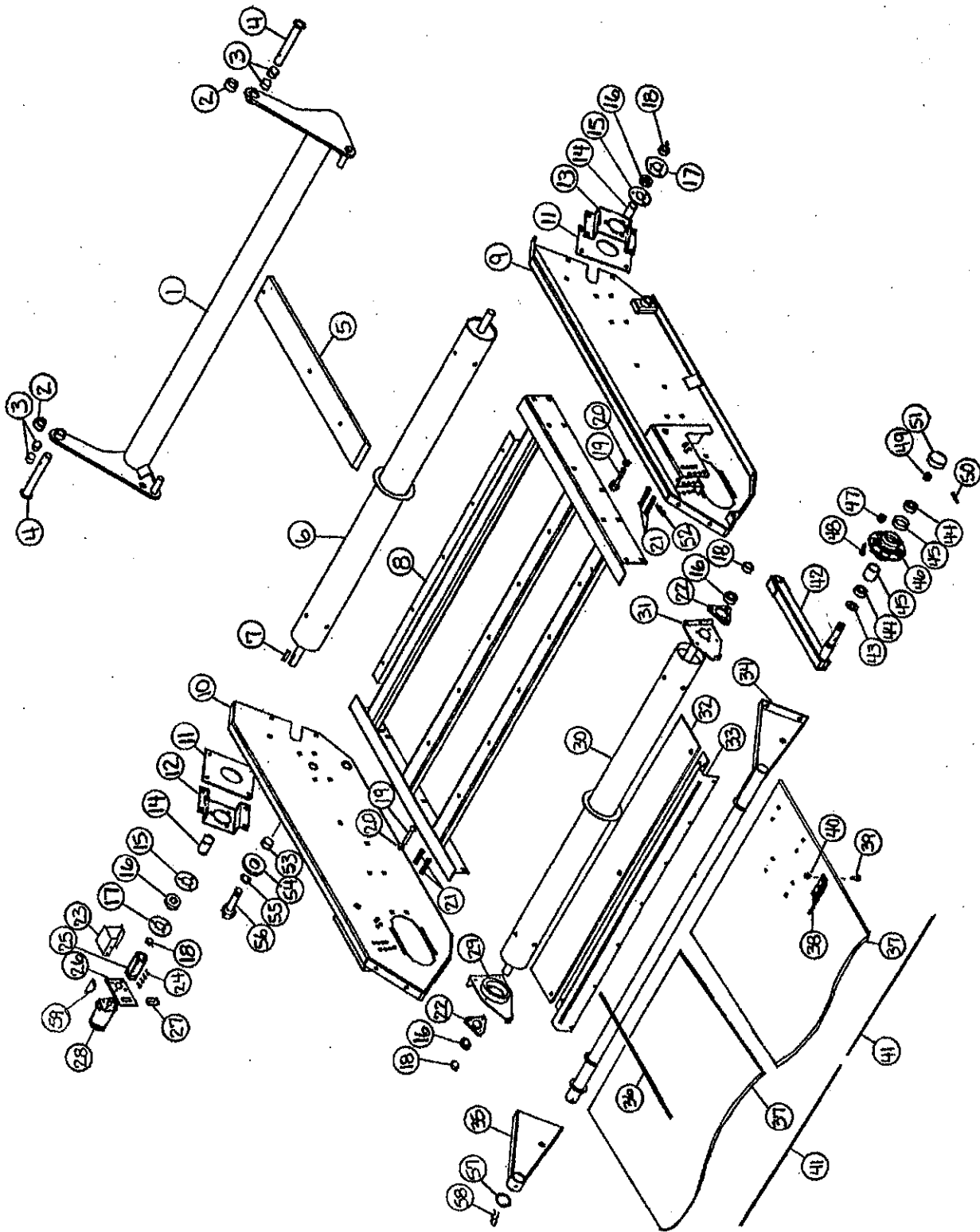

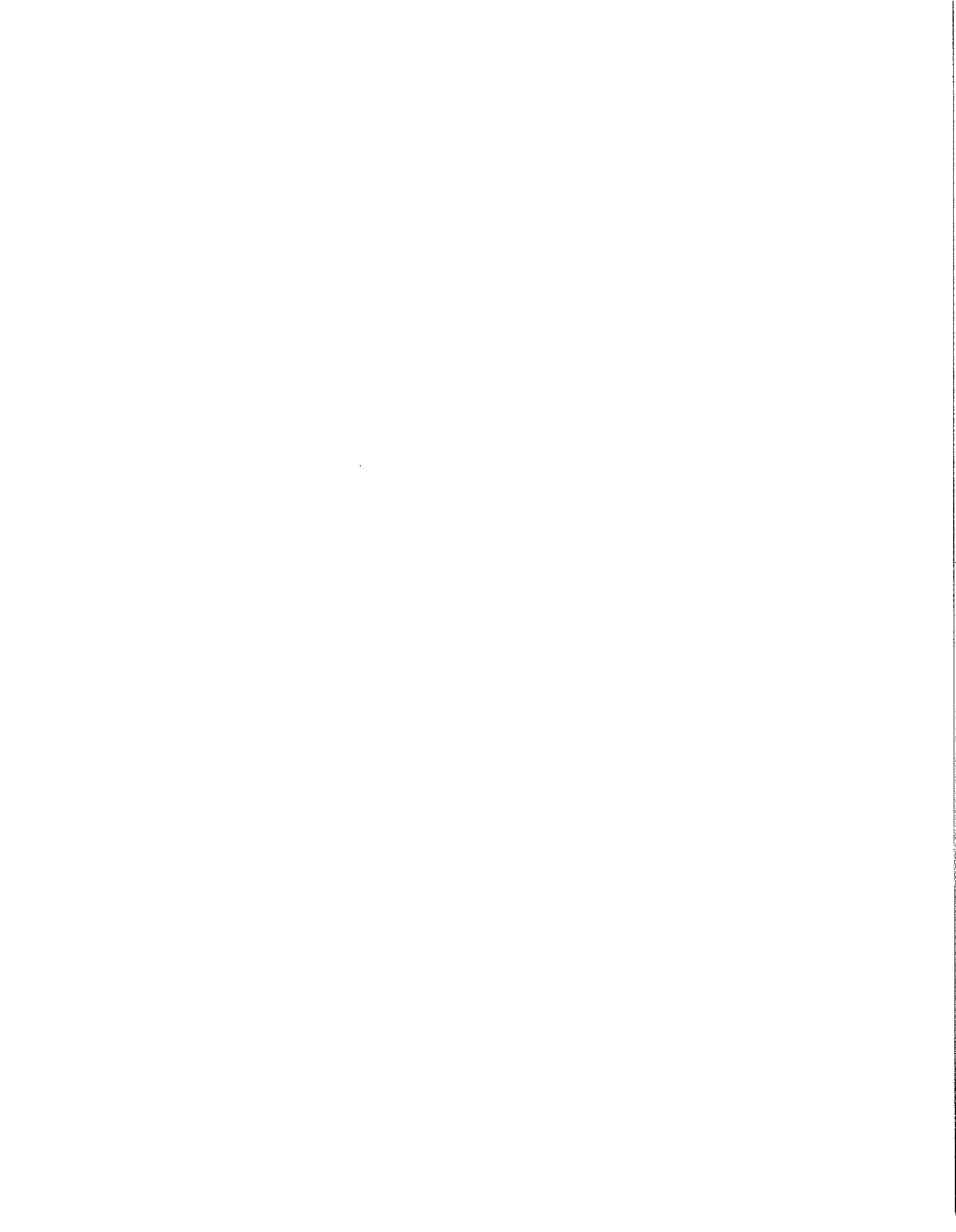

**FIGURE 2
6' & 9' MERGER PICK-UP HEAD**

ITEM	PART NO.		DESCRIPTION	ITEM	PART NO.		DESCRIPTION
	6' HEAD	9' HEAD			6' HEAD	9' HEAD	
1.	SWM12	WM230	Pickup Lifter	33.	SWM9	DWM2	Wind Guard Holder
2.	SWM30	"	Spacer	34.	SWM32	DWM228	Wind Guard
3.	RG132	"	Bushing 1-1/4"ID x 2" Long	35.	DWM226	"	Right Wind Guard
4.	SWM13	"	Pin	36.	WM60	"	Wind Guard Rods
5.	SWM15	"	Plastic Slides (5) 6' - (8) 9'	37.	SWM56	"	Pickup Belts Only (2) 6' - (3) 9'
6.	SWM77	WM341	Back Roller	*	SWM57	"	Pickup Belt Complete w/Teeth
7.	G23	"	Key 5/16" x 1-3/8"	*	SWM61	"	Repair Dutchman Kit
8.	SWM8	WM234	Pickup Belt Frame	*	SWM63	"	Repair Dutchman Kit 2003 & Newer
9.	DWM3	"	Left Panel				
10.	DWM4	"	Right Panel	38.	SWM1	"	Pickup Teeth (260)
11.	WM180	"	Side Panel Slot Plate	39.	SWM26	"	1/4" x 3/4" Elevator Bolts
12.	WM187	"	Bearing Bracket RH	40.	SWM27	"	1/4" Keps Lock Nuts
13.	WM186	"	Bearing Bracket LH	41.	SWM41	"	Lacing Pin
14.	WM343	"	PVC Spacer	*	SWM39	"	Alligator Lace
15.	F145	"	Heavy Duty Flange	42.	DWM229	"	Gauge Arms
16.	WM29	"	Bearing	43.	CAT135A	"	Seal
17.	F143	"	Flange W/45 Deg. Zerk	44.	CAT10	"	Bearing (2)
18.	WM27	"	Lock Collar	45.	CAT9	"	Race (2)
19.	DWM7	"	Pivot Pin	46.	CAT177	"	Hub-Complete
20.	R70	"	Cotter Pin 3/16" x 2"	47.	BFR144	"	Lug Nut
21.	DWM127	"	Clevis Pin	48.	CAT128	"	Stud
22.	SWM40	"	3-Bolt Bearing Housing	49.	CAT12	"	Spindle Nut
*	SWM35	"	3-Bolt Bearing Complete	50.	BFR65	"	Cotter Pin
23.	DWM43	"	Head Shield	51.	CAT13	"	Hub Cap
24.	DWM137	"	Cap Screw-Coupler	*	SWM17	"	Wheel (2)
25.	DWM27	"	Coupler	*	SWM18	"	Tire 5.70-8 (2)
26.	DWM39	"	Hydraulic Motor Mount	52.	ES7	"	Hair Pin
27.	DWM45	"	Motor Spacer	53.	WM183	"	Pivot Bushing
28.	WM177	"	Hydraulic Motor	54.	WM218	"	Washer
*	WM225	"	Seal Kit	55.	DWM171	"	1" Lock Washer
29.	WM179	"	Right Front Roller Bracket	56.	DWM177	"	Bolt 1" x 2-1/2" GR.5 Full Thd.
30.	SWM76	WM342	Front Roller	57.	DWM227	"	Wind Guard Washer
31.	WM192	"	Left Front Roller Bracket	58.	SWM55	"	Cotter Pin 1/4" x 2-1/2"
32.	SWM31	DWM58	Poly Wind Guard	59.	5B10	"	Key 1/4" x 1" Woodruff

* (Means Not Shown)

" (Means Same As Previous)

FIGURE 3

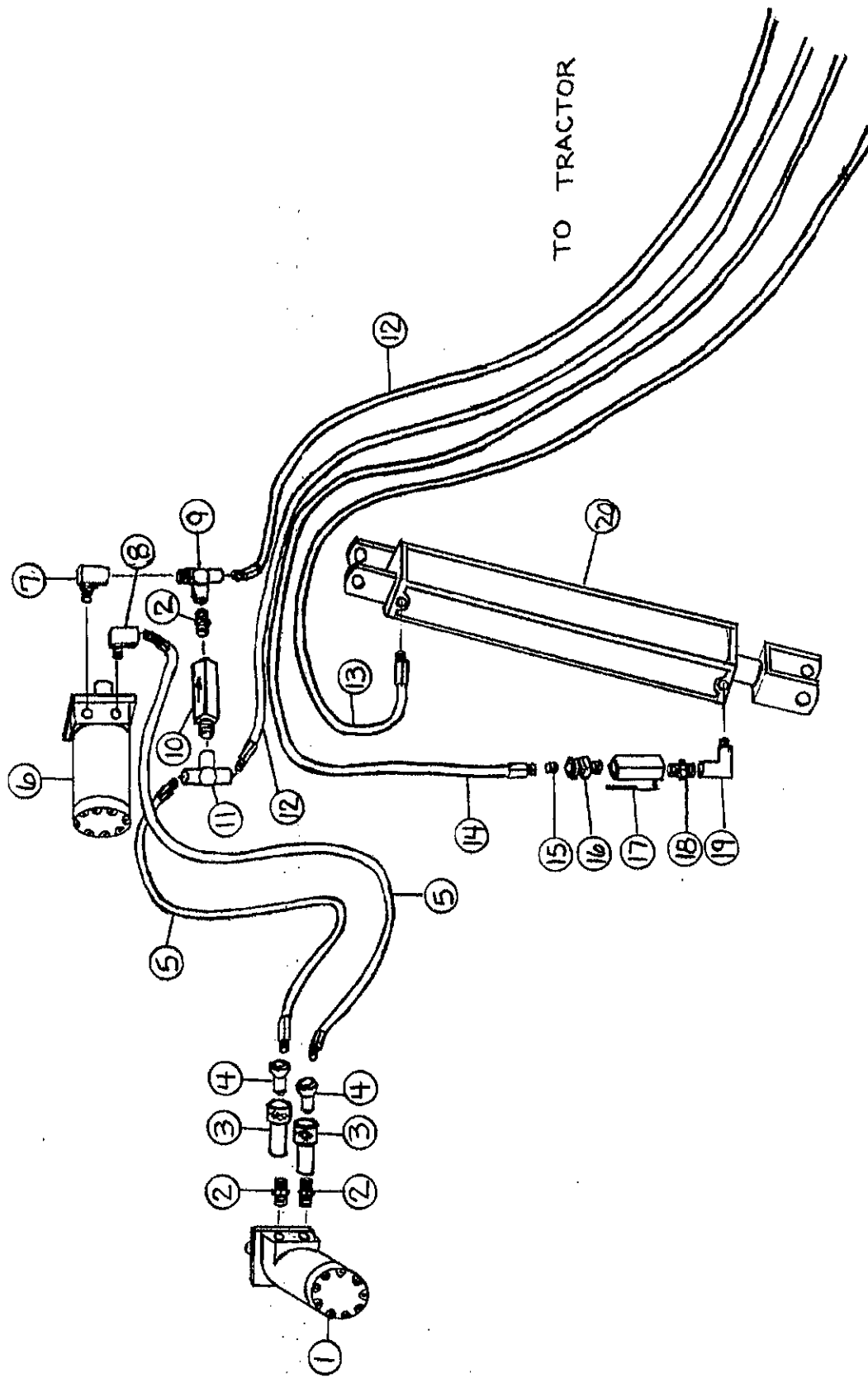

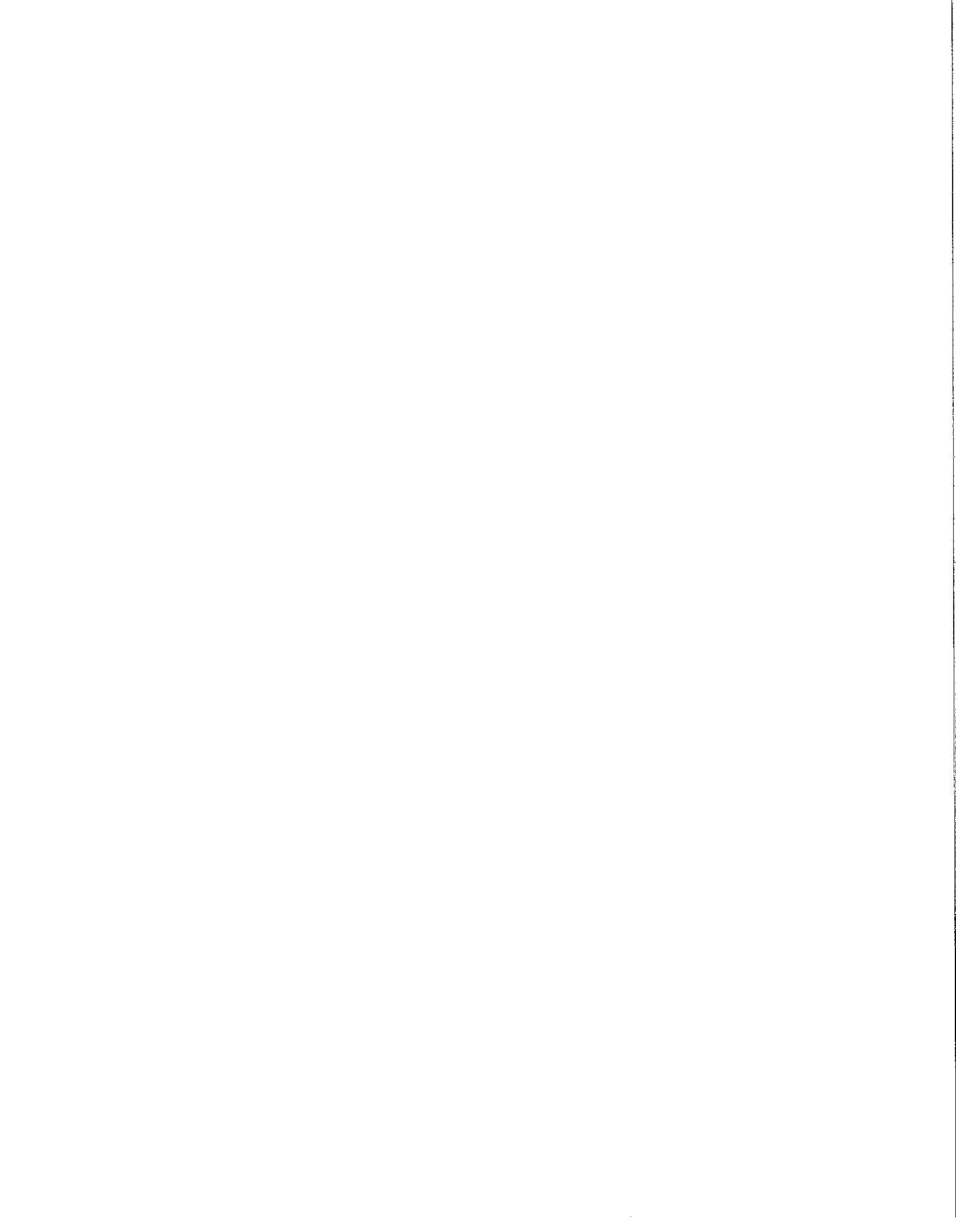

**FIGURE 3
6' & 9' MERGER HYDRAULICS**

ITEM	PART NO.		DESCRIPTION
	6' HEAD	9' HEAD	
1.	DF1	"	Hyd. Motor-Cross Conveyor
*	WM225	"	Seal Kit
2.	WM141	"	1/2" Nipple Nut
3.	DWM206	"	Female Coupler
4.	DWM205	"	Male Coupler
5.	SWM23	"	Hose 1/2" x 42"
6.	WM177	DWM84	Hyd. Motor-Pickup
*	WM225	"	Seal Kit
7.	LW174	"	1/2" Male Adapter Union
8.	HE58	"	1/2" Street Elbow
9.	LW96	"	1/2" Street Tee
10.	DF18	"	1/2" Check Valve
11.	DF8	"	1/2" Tee
12.	SWM22	----	Hose 1/2" x 216"
	----	SWM67	Hose 1/2" x 240"
13.	SWM24	----	Hose 1/4" x 180"
	----	SWM68	Hose 1/4" x 204"
14.	SWM25	----	Hose 1/4" x 190"
	----	SWM69	Hose 1/4" x 214"
15.	DWM250	"	Orifice .042
16.	BFR122	"	3/8" Male Adapter Union
*	T244	"	Adapter Union & Orifice
17.	16SV338	"	3/8" Ball Valve
18.	BFR188	"	3/8" Nipple Nut
19.	23N234	"	3/8" Street Elbow
20.	BFR69A	"	2" x 8" Cylinder

* (Means Not Shown)

" (Means Same As Previous)

---- (Means Not Used On This Model)

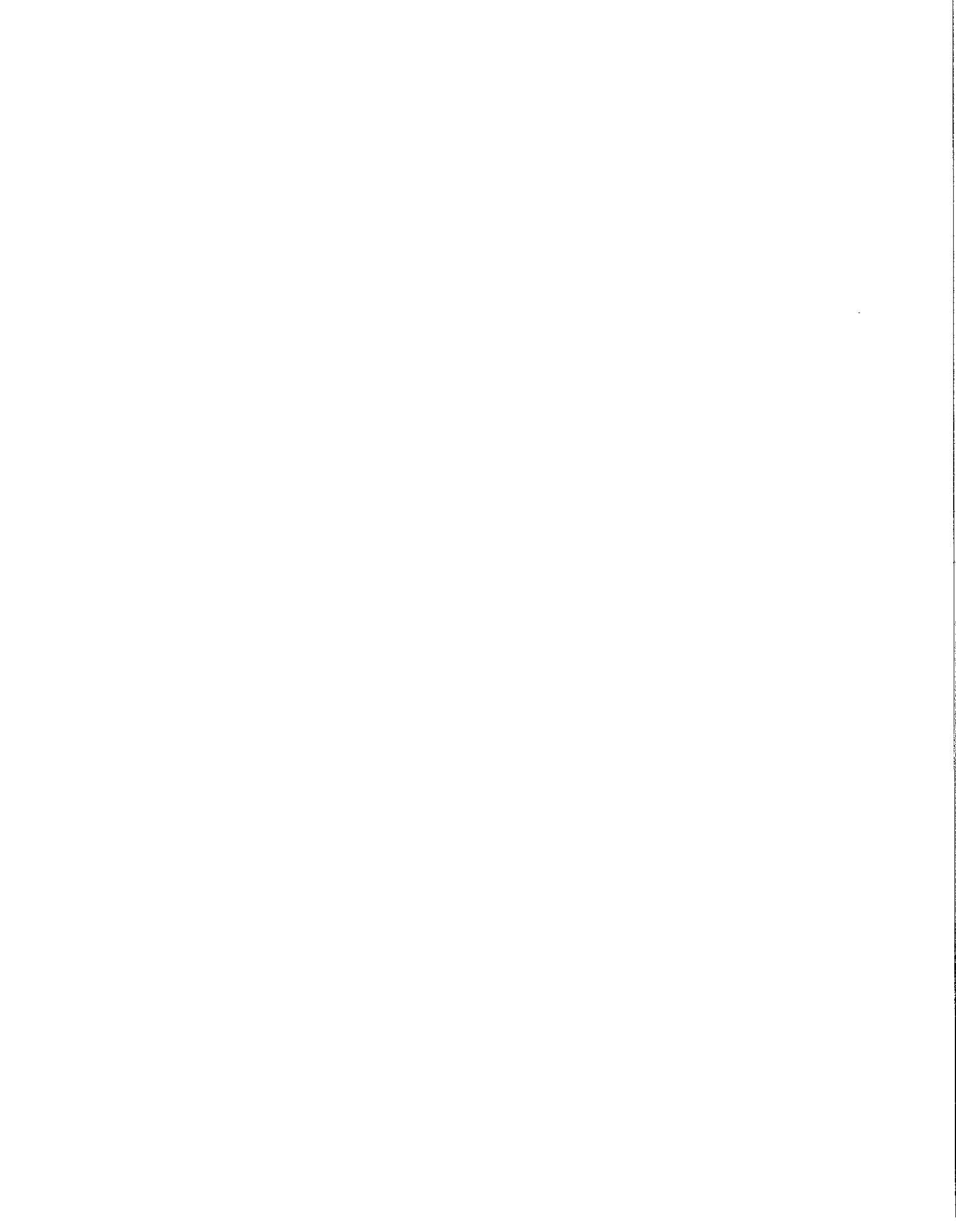

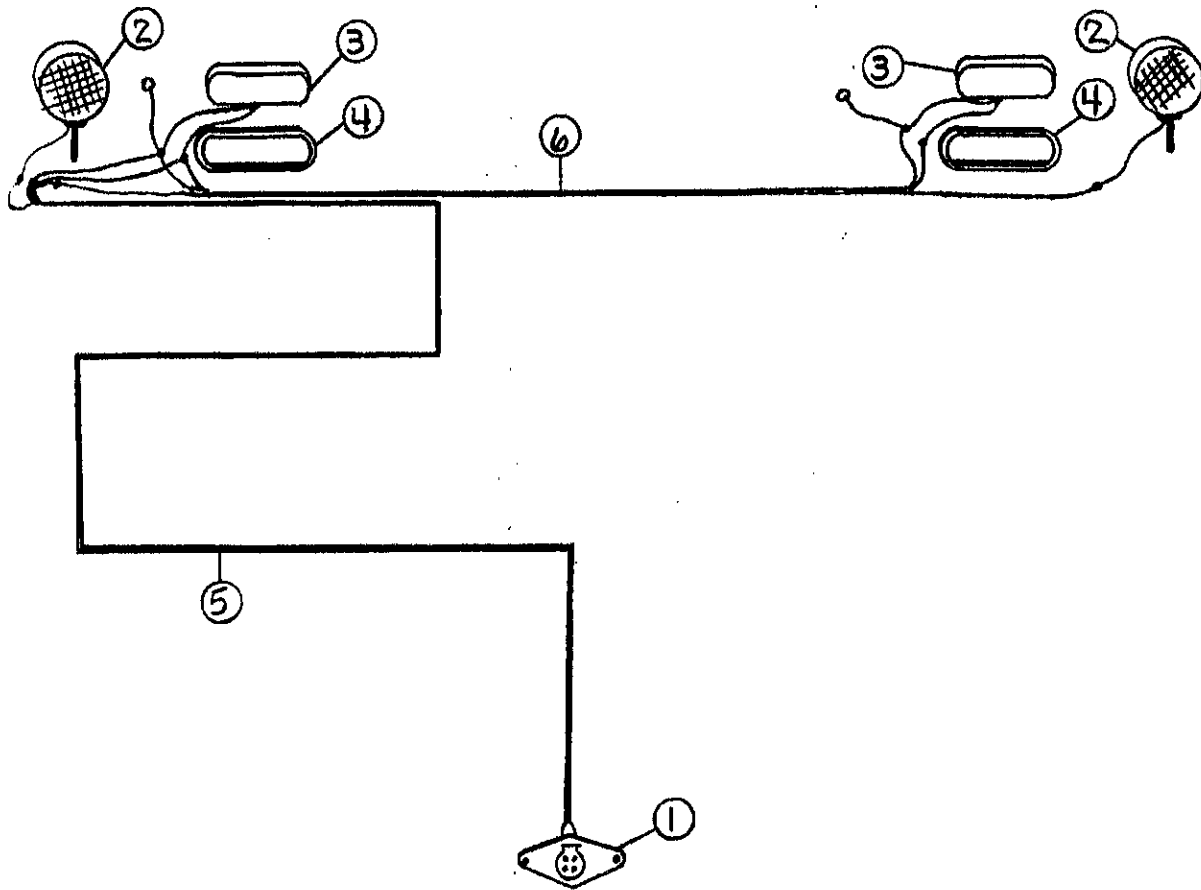

FIGURE 4
6' & 9' MERGER ELECTRICAL WIRING / LIGHTS

ITEM	PART NO.		DESCRIPTION
	6' HEAD	9' HEAD	
1.	SWM46	"	Plug In
2.	DWM129	"	Yellow Hazard Lights
3.	S310	"	Red Tail Lights
4.	S308	"	Rubber Light Mount
5.	SWM47	SWM70	Main Wire
6.	SWM48	SWM71	2nd Wire
7.	S317	"	Optional Tractor Cord

* (Means Not Shown)

" (Means Same As Previous)

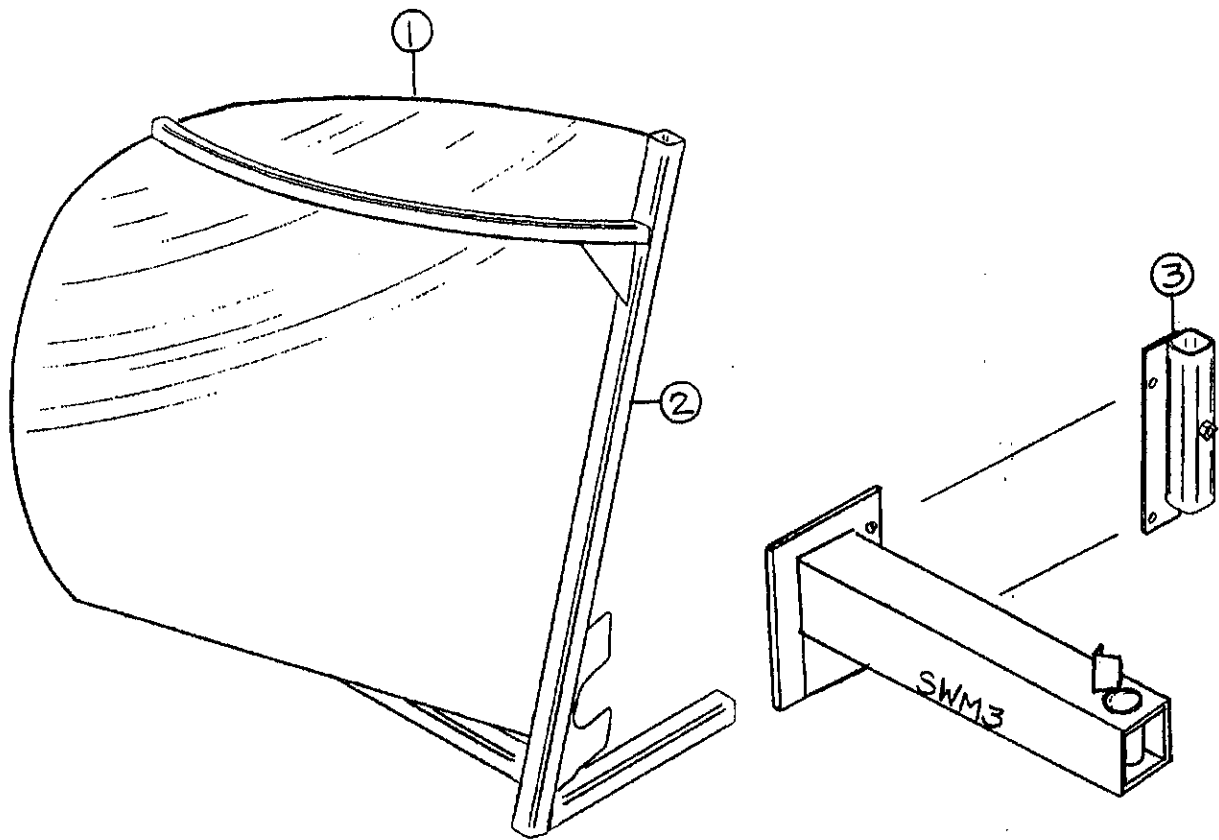

FIGURE 5
6' & 9' MERGER OPTIONAL WINDROW INVERTER

ITEM	PART NO.	DESCRIPTION
1.	SWM50	Windrow Inverter Poly
2.	SWM51	Windrow Inverter Frame
3.	SWM52	Storage Mount

(NOTE: Storage Mount Bolts onto SWM3 Caster Mount - See Fig. 1)



FIGURE 6

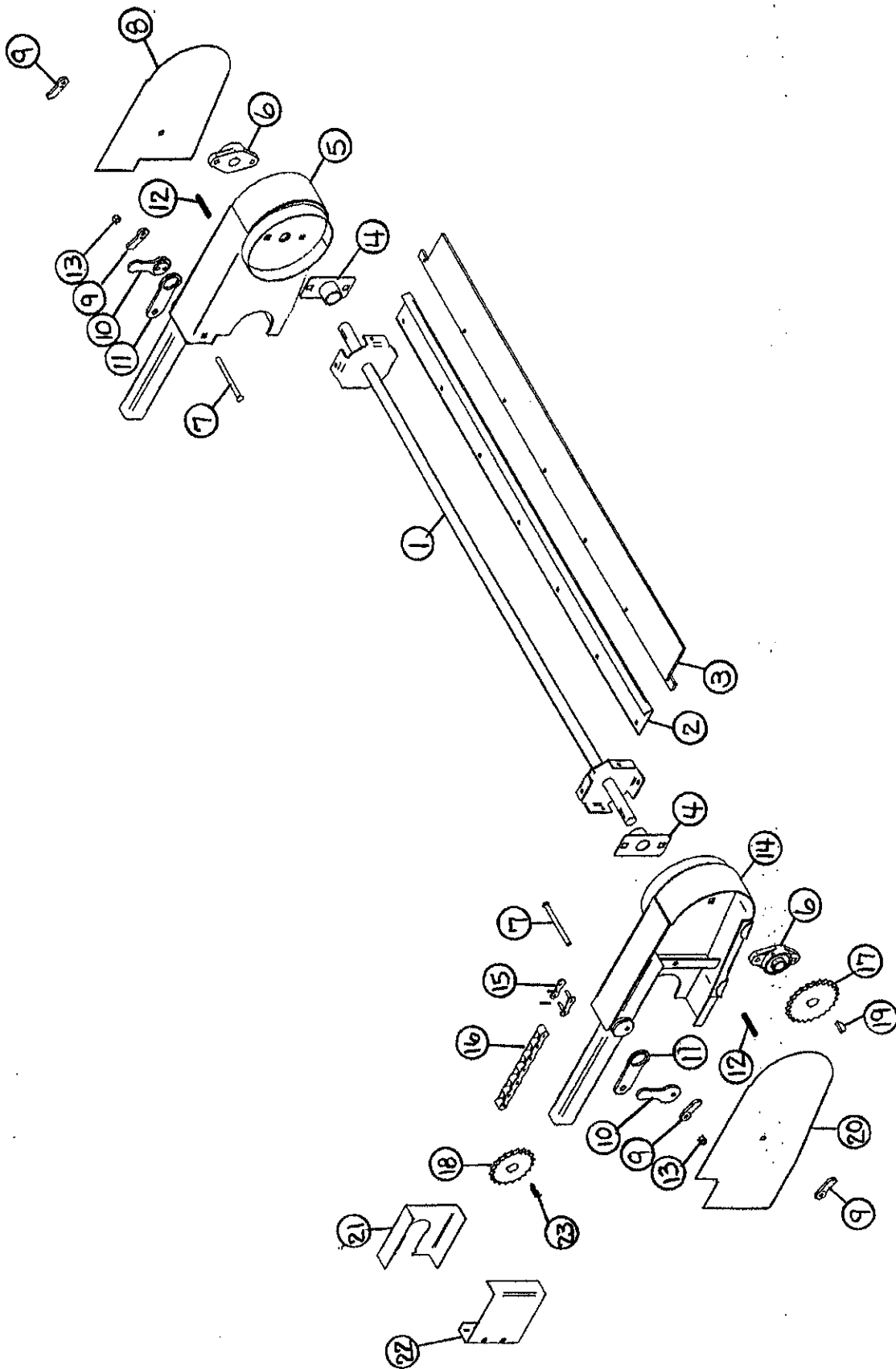
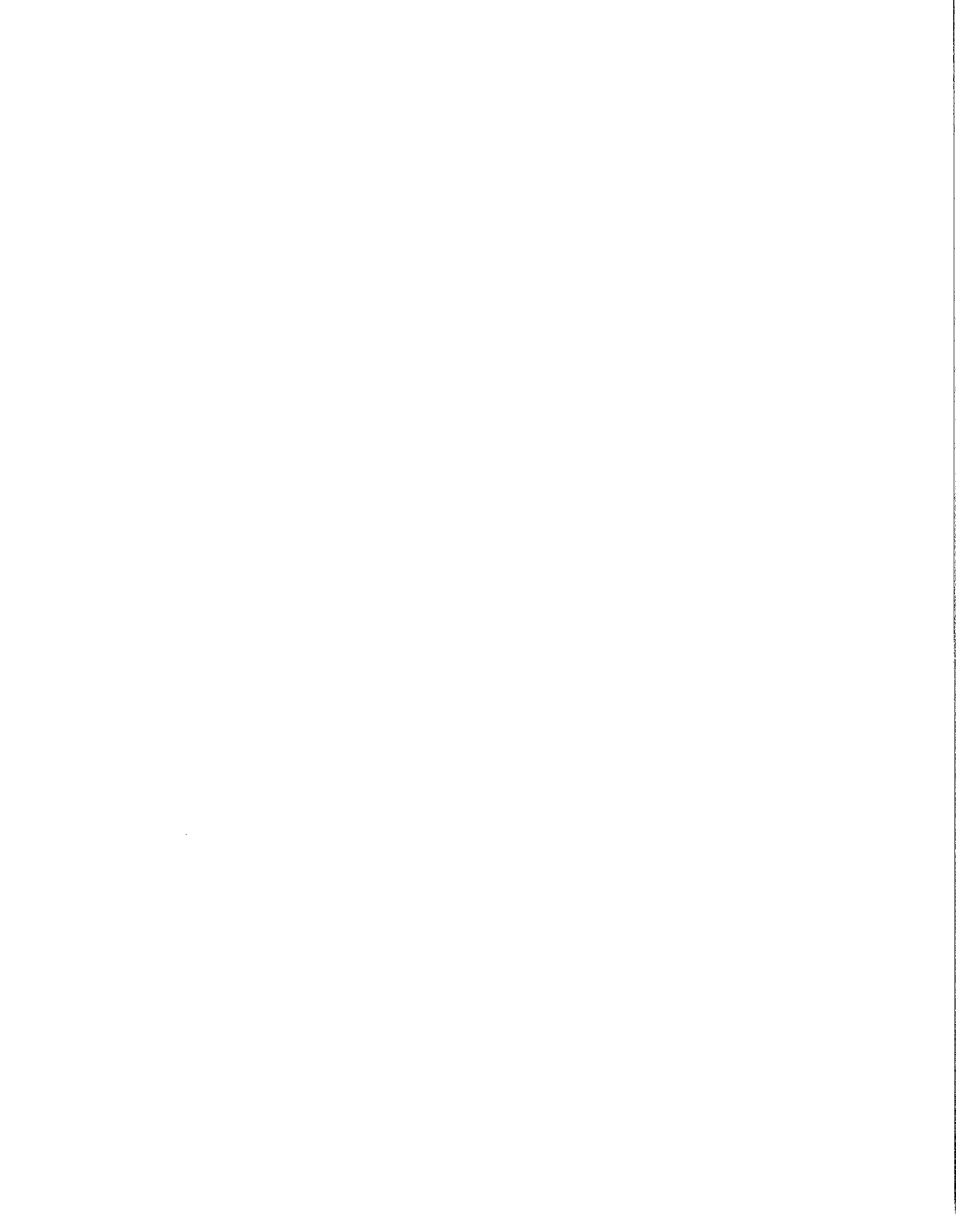

FIGURE 6
6' & 9' MERGER OPTIONAL ACCELERATOR

ITEM	PART NO.	DESCRIPTION
1.	SWM42	Accelerator Shaft
2.	SWM43	Accelerator Plate
3.	SWM44	Rubber
4.	DWM211	Wrap Guard
5.	DWM208	Mounting Bracket 1
6.	DWM221	1" Bearing
7.	DWM222	3/8" x 5-1/2" Carriage Bolt GR.5
8.	DWM214	Shield 1
9.	DWM219	Handle Nut
10.	DWM210	Latch Handle
11.	DWM217	Latch
12.	DWM218	Ready Rod
13.	A14	3/8" Nylock Nut
14.	DWM209	Mounting Bracket 2
15.	X61	#50 Connector Link
16.	SWM53	#50 Roller Chain 57 Pitch
17.	X106	Sprocket 24T 1" Bore
18.	SWM45	Sprocket 17T 1-1/4" Bore
19.	5B10	Woodruff Key 1/4" x 1"
20.	DWM213	Shield
21.	DWM216	Sprocket Shield Back
22.	DWM215	Sprocket Shield
23.	S135	1/4" x 1-1/4" Sq. Key
*	SWM58	Complete Accelerator Kit



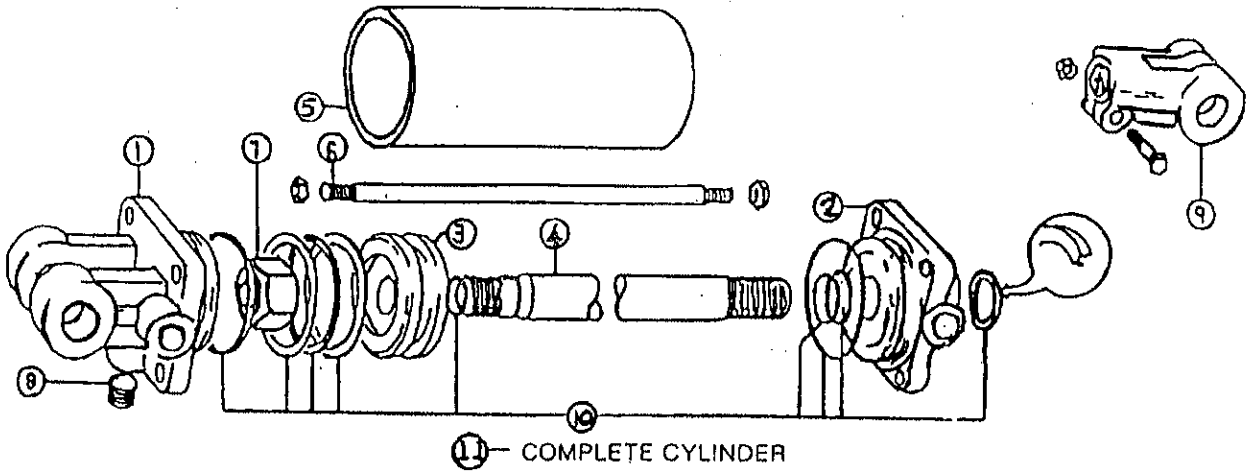

FIGURE 7
6' & 9' MERGER
HYDRAULIC CYLINDER 8"

ITEM	PART NO.	DESCRIPTION
1.	23N142A	Clevis Cap
2.	23N143A	Rod Cap
3.	23N144	Piston
4.	T184A	Rod
5.	BFR68	Cylinder Tube
6.	T186	Tie Rod
7.	23N148	Piston Nut
8.	23N149	Plug
9.	23N150A	Rod Clevis
10.	23N151	Seal Kit
11.	BFR69A	Complete Cylinder

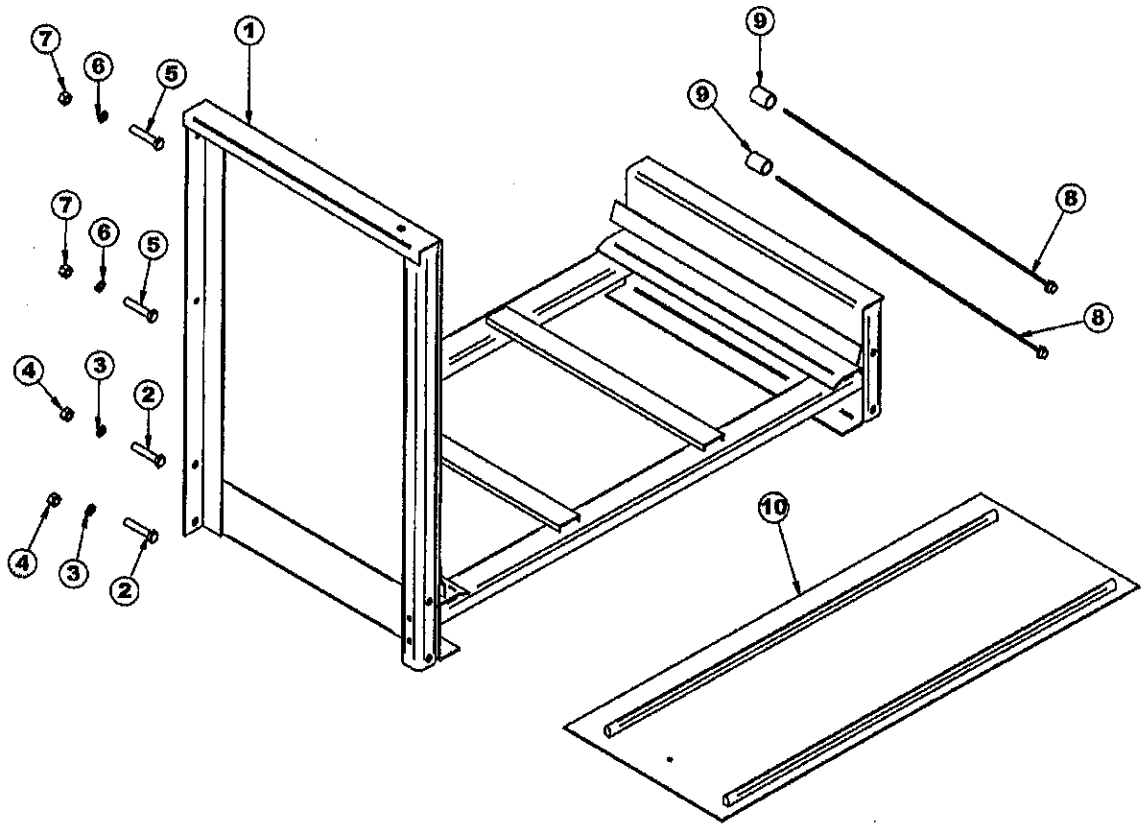
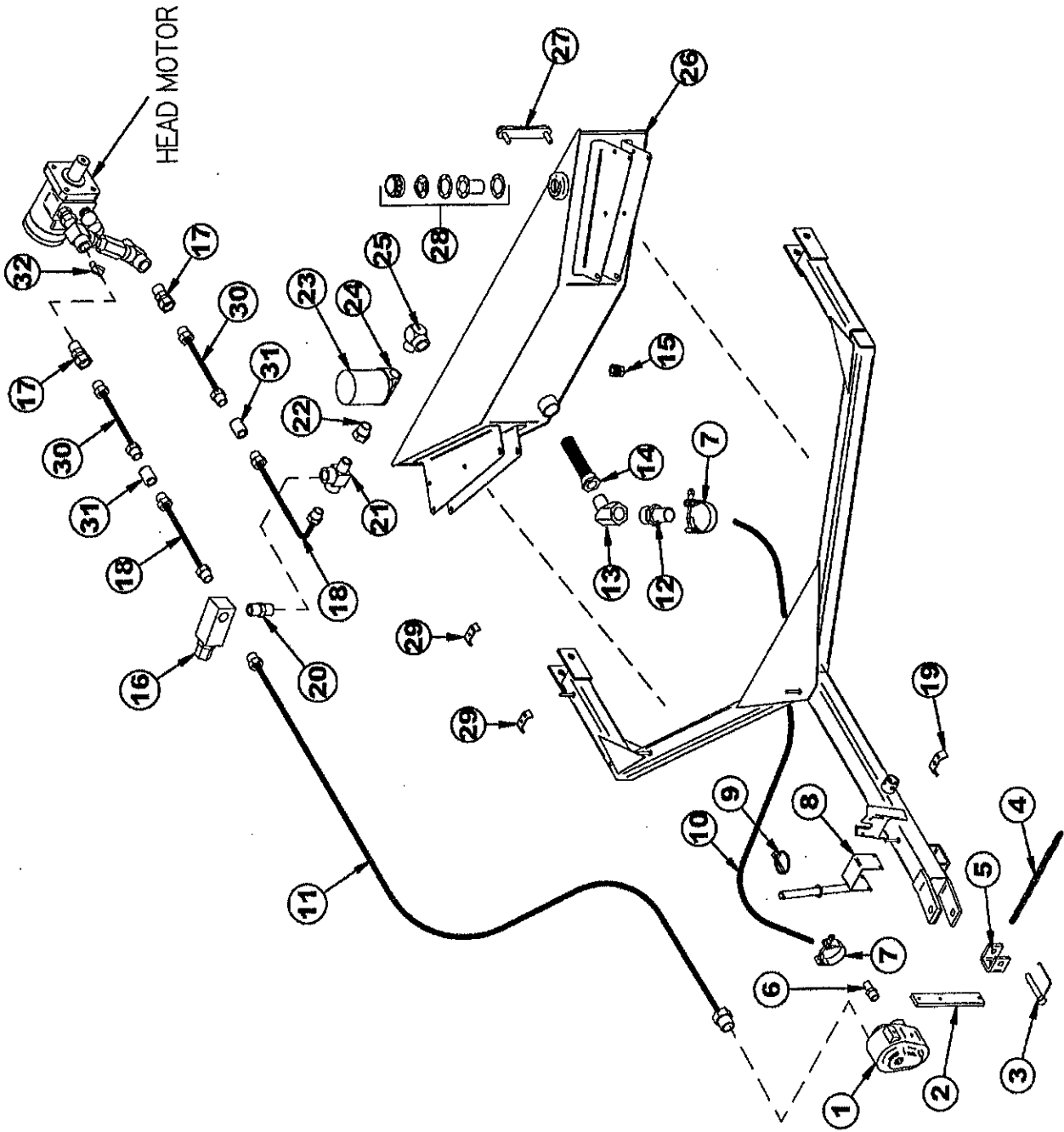

FIGURE 8
6' & 9' Merger 2' Extension

ITEM	PART NO.	DESCRIPTION
1.	SWM62	Extension
2.	WM328	1/2" x 2-3/4" Bolt Gr. 5
3.	R35	1/2" Lock Washer
4.	R29	1/2" Nut
5.	12N51	3/8" x 2-3/4" Bolt Gr. 5
6.	B68	3/8" Lock Washer
7.	K60	3/8" Nut
8.	16SV141	1/2" x 24" Hose (1/2"MP & 1/2"MPX)
9.	PB105	1/2" Pipe Coupler
10.	WM214	Belt Extension
*	WM220	Lacing Pin
*		30" - 16 Ga Wire

* (Means Not Shown)

FIGURE 9



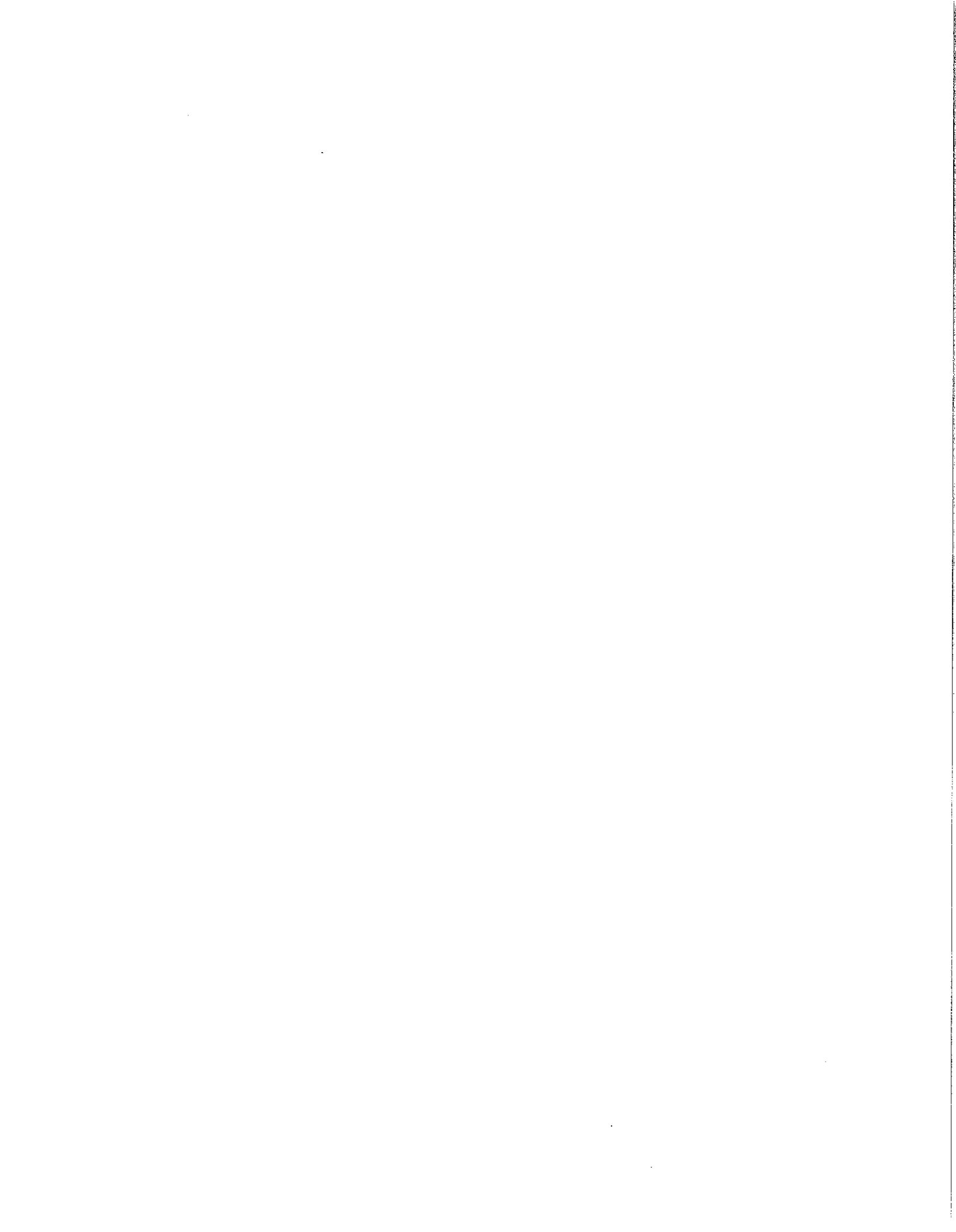

FIGURE 9
6' & 9' MERGER OPTIONAL WET KIT

ITEM	PART NO.	DESCRIPTION
1.	HSW4	PTO Pump (Rear Ports)
2.	WM168	Torque Arm
3.	DWM191	Snapper Pin
4.	BFR111	18 Links 1/4" Proof Chain
5.	HSW5	Chain Yoke
6.	HSW9	SAE 16 x 1-1/4 Hose Barb
7.	DWM138	Hose Clamp (Fit Over 1-3/4 OD)
8.	SWMW1	Storage Bracket
9.	F56	Clip Pin
10.	SWMW2	1-1/4" x 76" Suction Hose
11.	SWMW3	3/4" x 108" Hydraulic Hose #12SAE Swivel & 1/2MP
12.	DWM143	1-1/4 Hose Barb
13.	DWM118	45 Deg. Street 1-1/4 Elbow
14.	HSW2	Sump Strainer
15.	DWM159	3/4" Square Head Plug/Magnet
16.	HSW7	Relief Valve
17.	LW174	1/2" Male Union Adapters
18.	SWMW4	3/4" x 84" Hydraulic Hose 1/2MP & 1/2MP
19.	T223	Hose Clamp
20.	WM141	Nipple Nut 1/2"
21.	LW96	Service Tee 1/2"
22.	LW99	3/4" To 1/2" Bushing
23.	LW120 LW289	Filter
24.	LW119	Filter Base
25.	33SV72	3/4" Street Elbow
26.	SWMW5	Tank
27.	DWM204	Oil Level Gauge
28.	DWM81	Filler Cap Assembly
29.	HE42	Hose Clamp
30.	SWMW6	3/4" x 30" Hydraulic Hose 1/2" MP & 1/2" MP
31.	PB105	1/2" Pipe Coupler
32.	LW187	45° Street Elbow 1/2"

HSW22 Seal kit PTO pump

